

SMD Power Inductor CDRH65D43/DF

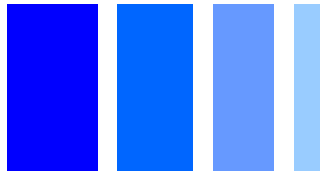

sumida

Under Development



Description

- Ferrite drum core construction.
- Magnetically shielded.
- L × W × H: 6.8 × 6.8 × 4.5 mm Max.
- Product weight: 0.7g(Ref.)
- Moisture Sensitivity Level: 1
- RoHS compliance.
- Halogen Free available.

Environmental Data

- Operating temperature range: -40°C ~ +105°C (including coil's self temperature rise)
- Storage temperature range: -40°C ~ +105°C
- Solder reflow temperature: 260 °C peak.

Packaging

- Carrier tape and reel packaging

Applications

- Ideally used in D Class Amplifiers .

Dimension - [mm]

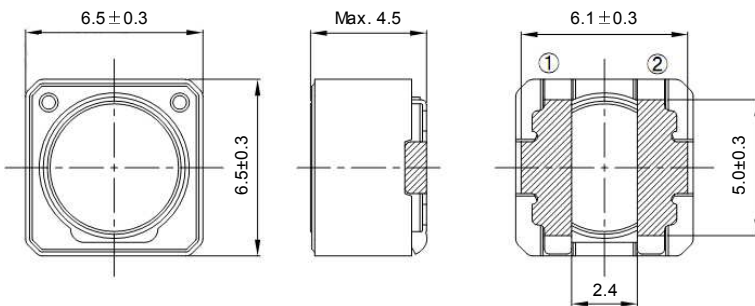

Land pattern and Schematics - [mm]

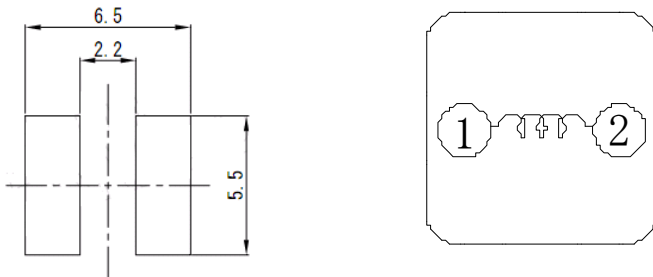

Electrical Characteristics

Part No.	Stamp	Inductance (μ H) ※1	D.C.R. (m Ω) Max. (Typ.) (at 20°C)	Saturation Current (A) ※2	Temperature Rise Current (A) ※3
CDRH65D43DFNP-100NC	A	10 ± 25%	50(42)	2.80	2.80
CDRH65D43DFNP-150NC	B	15 ± 25%	96(80)	2.30	1.85
CDRH65D43DFNP-220NC	C	22 ± 25%	150(125)	1.80	1.55
CDRH65D43DFNP-330NC	D	33 ± 25%	228(190)	1.50	1.30

※1. Inductance measuring condition: at 100kHz.

※2. Saturation current: The value of D.C. current when the inductance decreases to 80% of it's nominal value.

※3. Temperature rise current: The value of D.C. current when the temperature rise is $\Delta t = 40^\circ\text{C}$ ($T_a = 20^\circ\text{C}$).

SMD Power Inductor CDRH65D43/DF

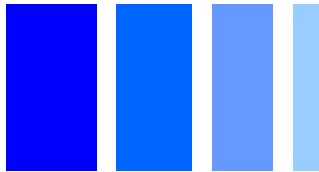

Under Development

Saturation Current & Temperature Rise Graph

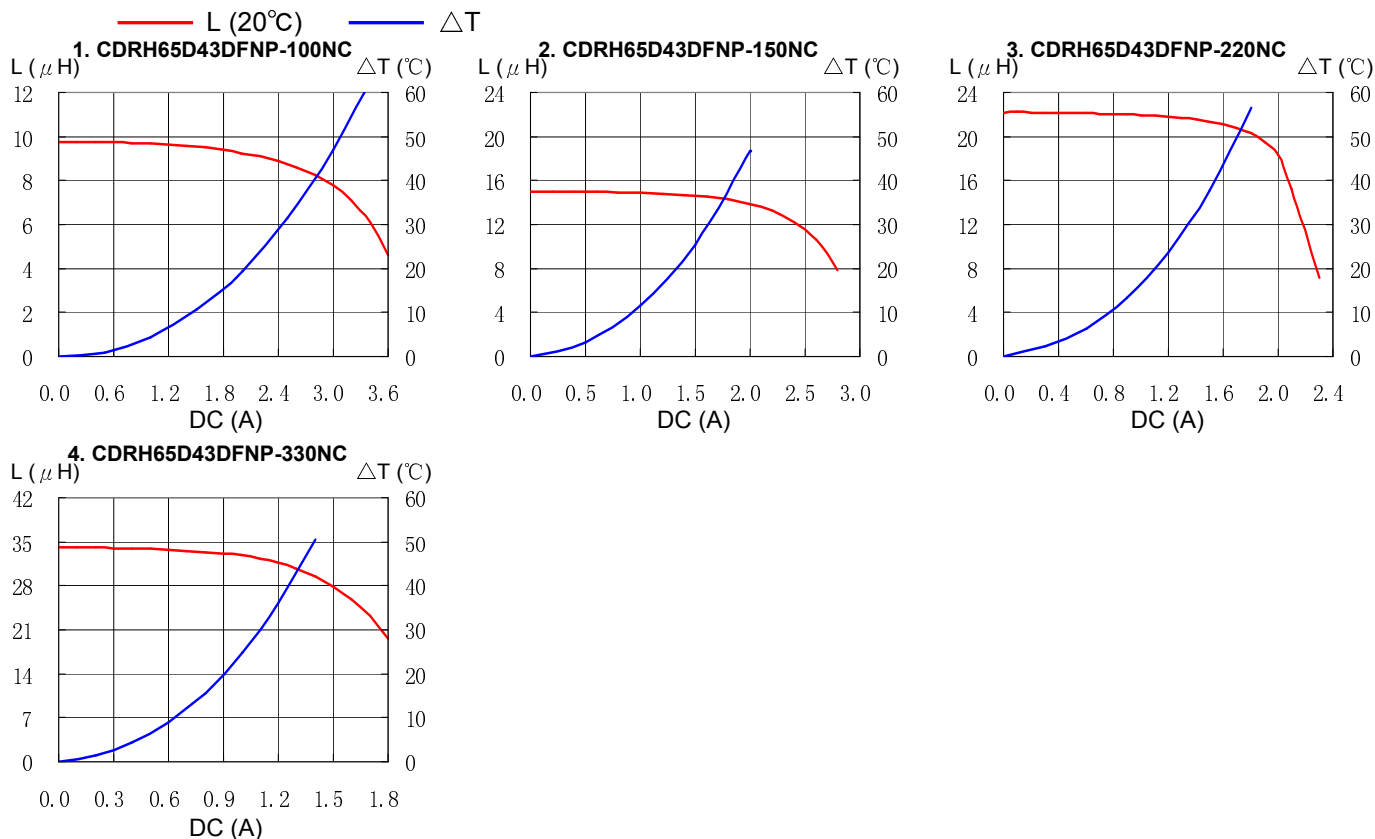

Solder Reflow Condition

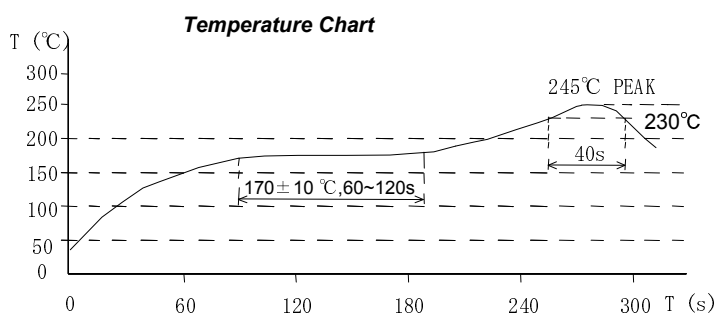
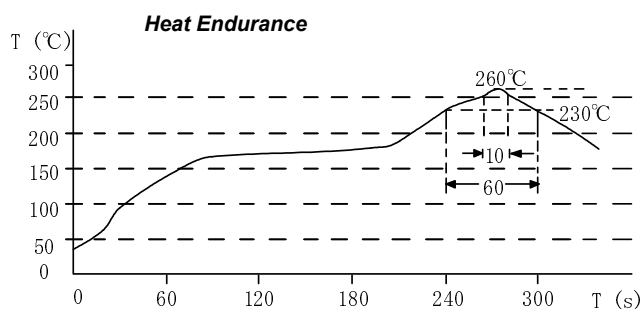

Please refer to the sales offices on our website - <http://www.sumida.com>

Hong Kong
 Tel.+852-2880-6688
 FAX.+852-2565-9600
sales@hk.sumida.com
Tokyo
 Tel.+81-3-5202-7112
 FAX.+81-3-5202-7105
sales@jp.sumida.com
Chicago
 Tel.+1-847-545-6700
 FAX. +1-847-545-6720
sales@us.sumida.com

Shanghai
 Tel.+86-021-5836-3299
 FAX.+86-021-5836-3266
shanghai.sales@cn.sumida.com
Seoul
 Tel.+82-2-6237-0777
 FAX.+82-2-6237-0778
sales@kr.sumida.com
Oberzell
 Tel.+49-8591-937-0
 FAX. +49-8591-937-103
contact@sumida-eu.com

Shenzhen
 Tel.+86-755-8291-0228
 FAX.+86-755-8291-0338
shenzhen.sales@cn.sumida.com
Singapore
 Tel.+65-6296-3388
 FAX.+65-6296-3390
sales@sg.sumida.com
Neumarkt
 Tel.+49-9181-4509-110
 FAX. +49-9181-4509-310
infocomp@eu.sumida.com

Taipei
 Tel.+886-2-8751-2737
 FAX.+886-2-8751-2738
sales@tw.sumida.com
San Jose
 Tel.+1-408-321-9660
 FAX.+1-408-321-9308
sales@us.sumida.com