

SMD Power Inductor CDH30D11D/MB



Halogen Free



Description

- Ferrite drum core construction.
- Semi-shielded with ferrite powder.
- L × W × H: 3.2 × 3.1 × 1.2 mm Max.
- Product weight: 38mg(Ref.)
- Moisture Sensitivity Level: 1
- RoHS compliance.
- Halogen Free available.

Environmental Data

- Operating temperature range: -40°C~+105°C (including coil's self temperature rise)
- Storage temperature range: -40°C~+105°C
- Solder reflow temperature: 260 °C peak.

Packaging

- Carrier tape and reel packaging.
- 13.0" diameter reel
- 4000pcs per reel

Applications

- Ideally used in Mobile phone, PDA, MP3, DVC/DSC, HDD etc. as DC-DC converter inductors.

Dimension - [mm]

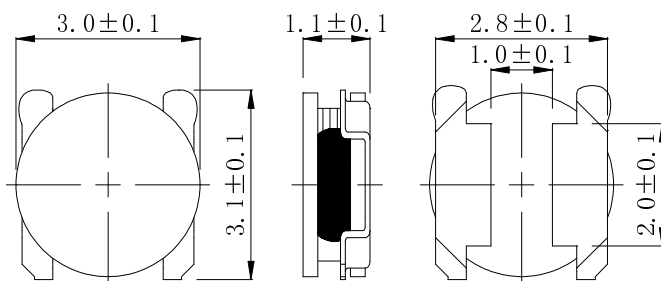

Land pattern and Schematics - [mm]

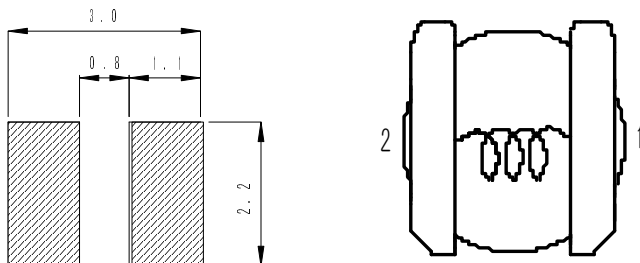

Electrical Characteristics

Part No.	Stamp	Inductance (μH) [within] ※1	D.C.R. (mΩ) [within] (at 20°C)	Saturation current (A) (at 20°C) ※2	Temperature rise current (A) ※3
CDH30D11DMBHF-1R0NC	A	1.0 ± 30%	45 ± 25%	1.96	2.40
CDH30D11DMBHF-1R5NC	C	1.5 ± 30%	53 ± 25%	1.63	2.20
CDH30D11DMBHF-2R2MC	E	2.2 ± 20%	68 ± 25%	1.40	1.95
CDH30D11DMBHF-3R3MC	G	3.3 ± 20%	95 ± 25%	1.15	1.70
CDH30D11DMBHF-4R7MC	J	4.7 ± 20%	170 ± 20%	0.96	1.27
CDH30D11DMBHF-6R8MC	L	6.8 ± 20%	225 ± 20%	0.79	1.06
CDH30D11DMBHF-100MC	N	10 ± 20%	360 ± 20%	0.66	0.80
CDH30D11DMBHF-150MC	Q	15 ± 20%	560 ± 20%	0.53	0.67

※1. Inductance measuring condition: at 100kHz.

※2. Saturation current: The value of D.C. current when the inductance decreases to 70% of it's nominal value.

※3. Temperature rise current: The value of D.C. current when the temperature rise is Δt=40°C (Ta=20°C).

SMD Power Inductor CDH30D11D/MB

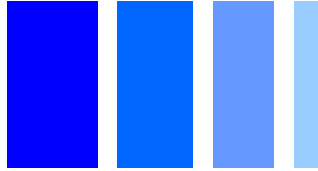

Saturation Current & Temperature Rise Graph

— L (20°C) — L (105°C) — ΔT

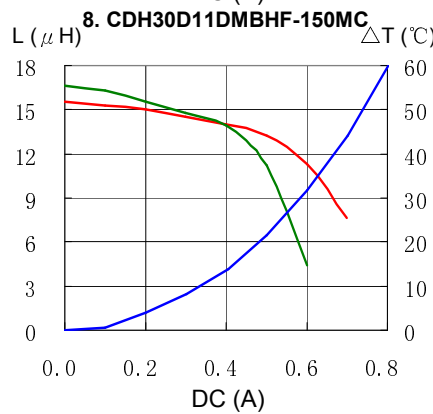
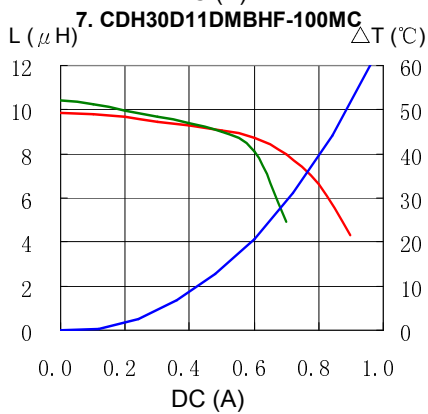
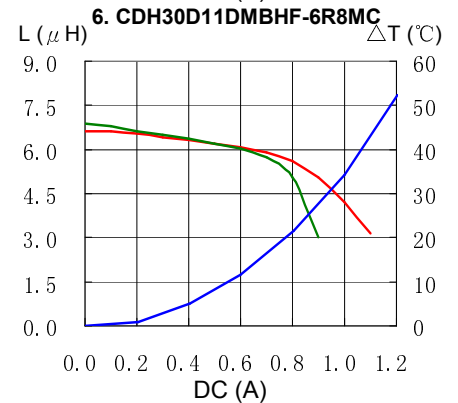
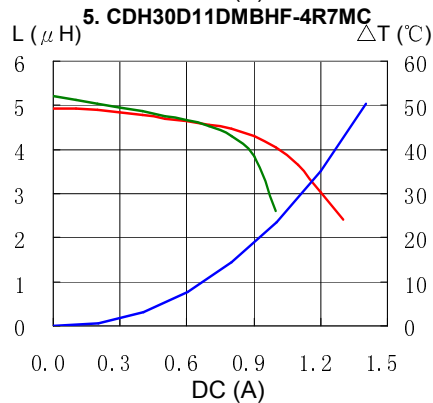
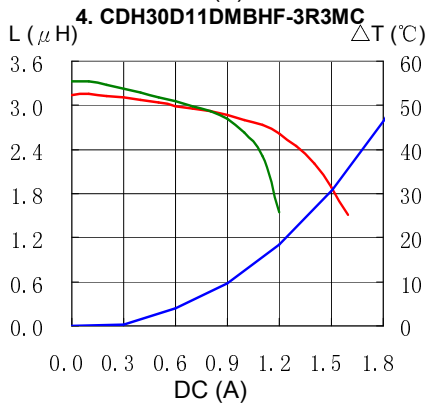
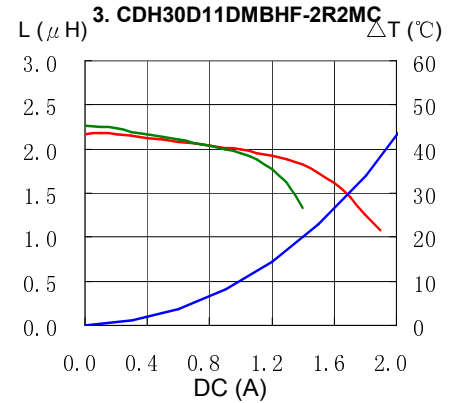
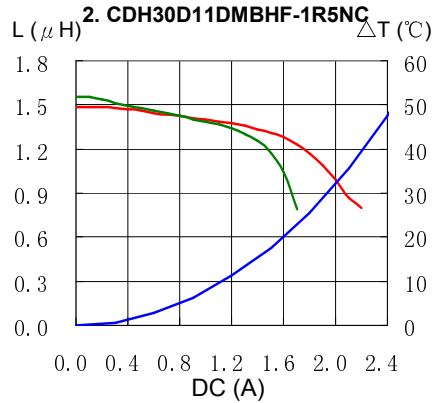
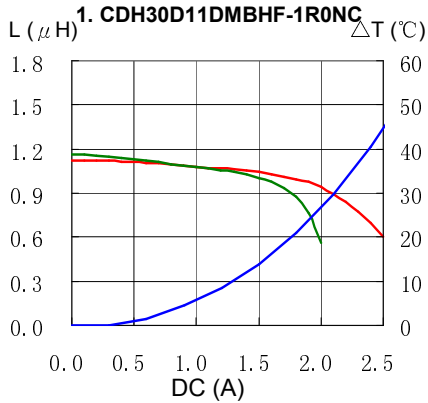

SMD Power Inductor CDH30D11D/MB



Solder Reflow Condition

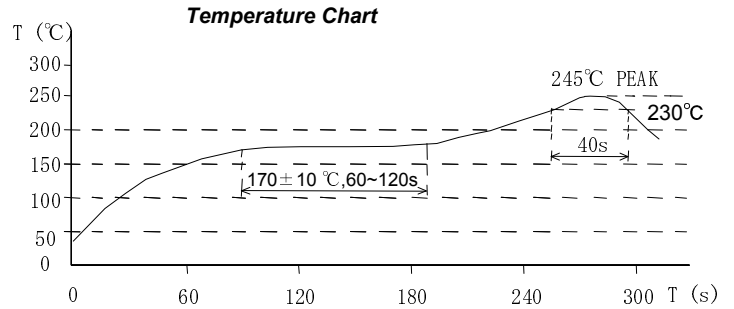
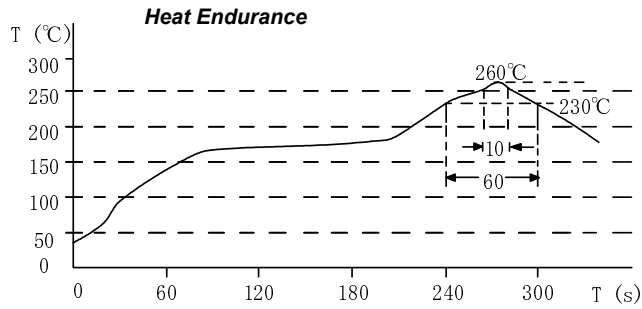

Please refer to the sales offices on our website - <http://www.sumida.com>

Hong Kong

Tel.+852-2880-6688
FAX.+852-2565-9600
sales@hk.sumida.com

Tokyo

Tel.+81-3-5202-7112
FAX.+81-3-5202-7105
sales@jp.sumida.com

Chicago

Tel.+1-847-545-6700
FAX. +1-847-545-6720
sales@us.sumida.com

Shanghai

Tel.+86-021-5836-3299
FAX.+86-021-5836-3266
shanghai.sales@cn.sumida.com

Seoul

Tel.+82-2-6237-0777
FAX.+82-2-6237-0778
sales@kr.sumida.com

Oberzell

Tel.+49-8591-937-0
FAX. +49-8591-937-103
contact@sumida-eu.com

Shenzhen

Tel.+86-755-8291-0228
FAX.+86-755-8291-0338
shenzhen.sales@cn.sumida.com

Singapore

Tel.+65-6296-3388
FAX.+65-6296-3390
sales@sg.sumida.com

Neumarkt

Tel.+49-9181-4509-110
FAX. +49-9181-4509-310
infocomp@eu.sumida.com

Taipei

Tel.+886-2-8751-2737
FAX.+886-2-8751-2738
sales@tw.sumida.com

San Jose

Tel.+1-408-321-9660
FAX.+1-408-321-9308
sales@us.sumida.com