

BRIGHT LED ELECTRONICS

● Device Number : BPI-3C2-05

Version: 1.0

● Absolute Maximum Rating (Ta=25°C)

Page: 2

| Item | | Symbol | Rating | Unit |
|----------------------------|-----------------------------|------------------|------------|------|
| Input | Power Dissipation | Pd | 75 | mW |
| | Reverse Voltage | V _R | 5 | V |
| | Forward Current | I _F | 50 | mA |
| | Peak Forward Current (*1) | I _{FP} | 1 | A |
| Output | Collector Power Dissipation | P _C | 100 | mW |
| | Collector Current | I _C | 20 | mA |
| | C-E Voltage | V _{CEO} | 30 | V |
| | E-C Voltage | V _{ECO} | 5 | V |
| Operating Temperature | | Topr | -25 ~ +85 | °C |
| Storage Temperature | | Tstg | -40 ~ +100 | °C |
| Soldering Temperature (*2) | | Tsol | 260 | °C |

(*1) tw=100 uSec., T=10 mSec.

(*2) t=5 Sec

● Electrical Optical Characteristics (Ta=25°C)

| Parameter | | Symbol | Condition | Min. | Typ. | Max. | Unit |
|---------------|------------------------|----------------------|--|------|------|------|------|
| Input | Forward Voltage | V _F | I _F =20mA | — | 1.2 | 1.5 | V |
| | Reverse Current | I _R | V _R =5V | — | — | 100 | μA |
| | Peak Wavelength | λ _p | I _F =10mA | | 940 | | nm |
| Output | Dark Current | I _D | V _{CE} =10V | — | — | 100 | nA |
| | C-E Saturation Voltage | V _{CE(sat)} | I _C =0.25mA I _F =10mA | — | — | 0.4 | V |
| Light Current | | I _L | V _{CE} =5V I _F =10mA | 0.5 | — | 5 | mA |
| Speed | Rise Time | Tr | I _{FP} =20mA V _{CE} =5V | — | 20 | — | μsec |

| | | | | | | | |
|--|-----------|----|------------------|---|----|---|-----------|
| | Fall Time | Tf | $R_L=1000\Omega$ | — | 20 | — | μ sec |
|--|-----------|----|------------------|---|----|---|-----------|

BRIGHT LED ELECTRONICS

- Device Number : BPI-3C2-05
- Package Dimensions

Page: 3
Version: 1.1

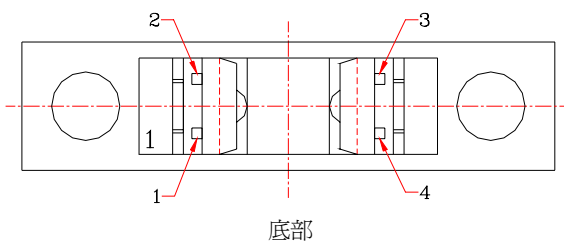
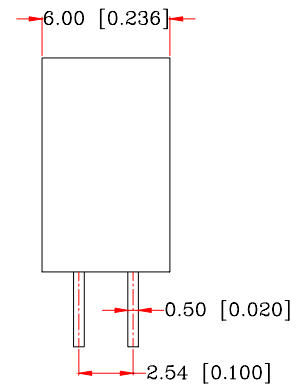
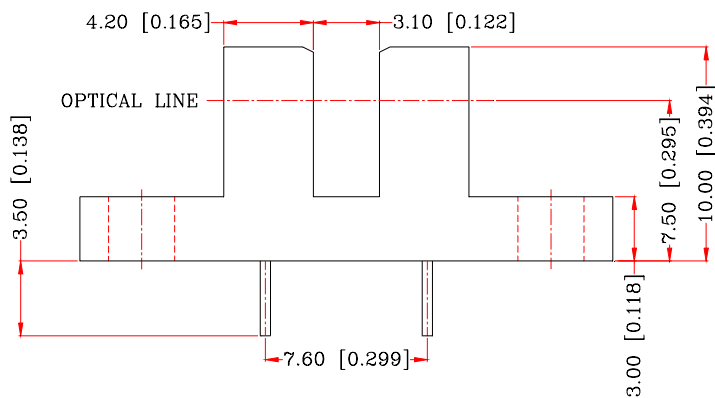
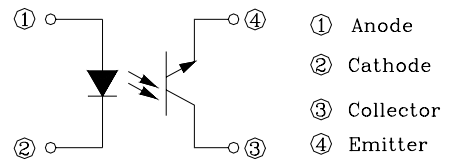
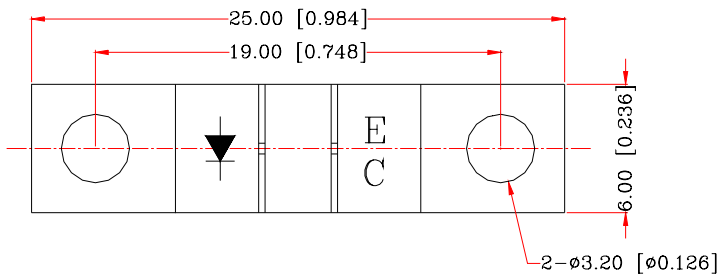

Notes:

1. All dimensions are in millimeters(inches).
2. Tolerance is ϕ 0.25mm unless otherwise specified.
3. Lead spacing is measured where the leads emerge from the package.
4. Specifications are subject to change without notice.

BRIGHT LED ELECTRONICS

● Device Number : BPI-3C2-05

Page: 4

● Typical Electrical / Optical Characteristics Curves (Ta=25°C)

Version: 1.0

Fig.1 Power Dissipation vs. Ambient Temperature

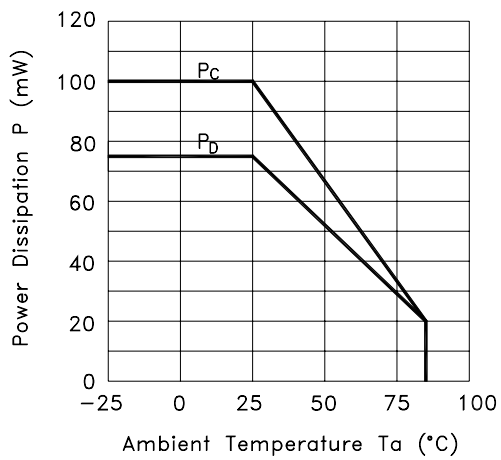

Fig.2 Forward Current vs. Forward Voltage

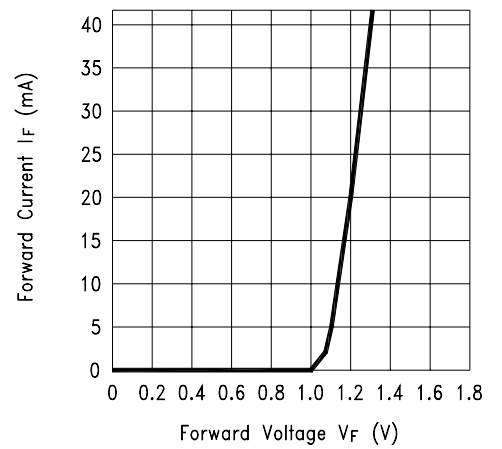

Fig.3 Collector Current vs. Collector-emitter Voltage

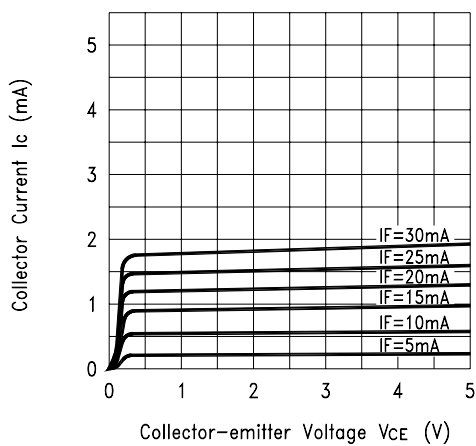
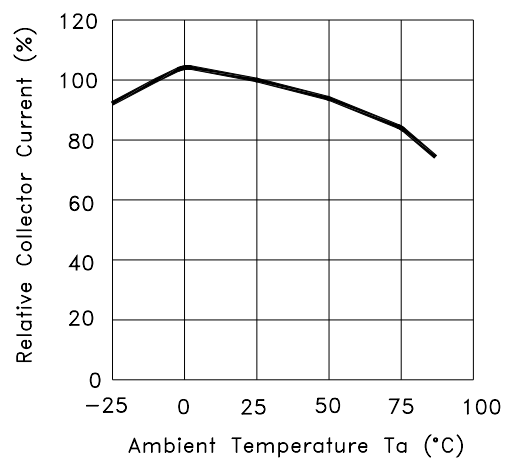

Fig.4 Collector Current vs. Ambient Temperature



BRIGHT LED ELECTRONICS

● Device Number : BPI-3C2-05

Page: 5

● Typical Electric / Optical Characteristics Curves (Ta=25°C)

Version: 1.0

Fig.5 Collector-emitter Saturation Voltage vs. Ambient Temperature

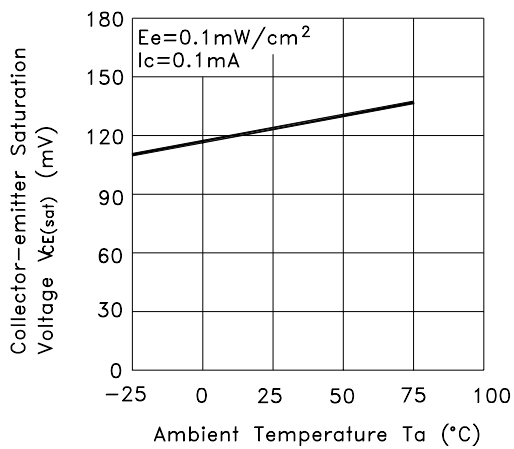

Fig.6 Response Time vs. Load Resistance

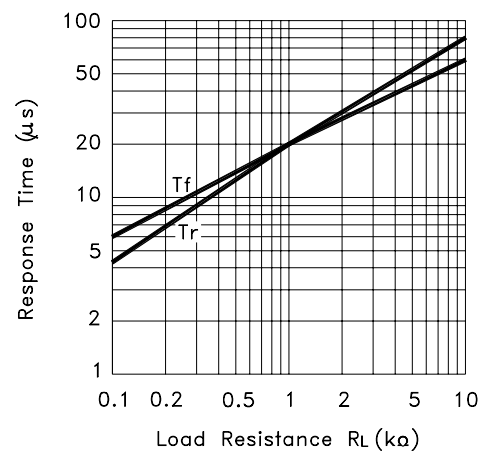
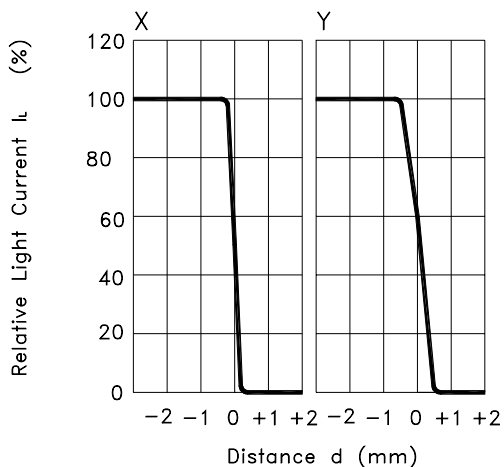
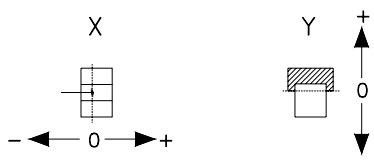

Fig.7 Sensing Position Characteristics (Typical)



(Center of Optical axis)



Test Circuit for Response Time

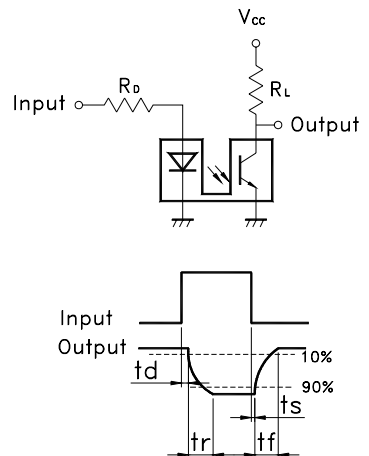

BRIGHT LED ELECTRONICS

- Device Number : BPI-3C2-05
- Packaging Box Dimensions

Page: 6
Version: 1.1

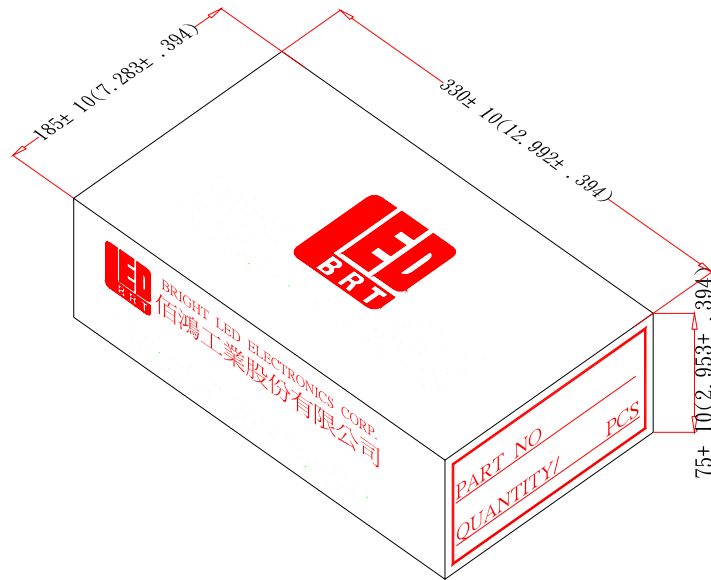

- Packaging Bag Dimensions

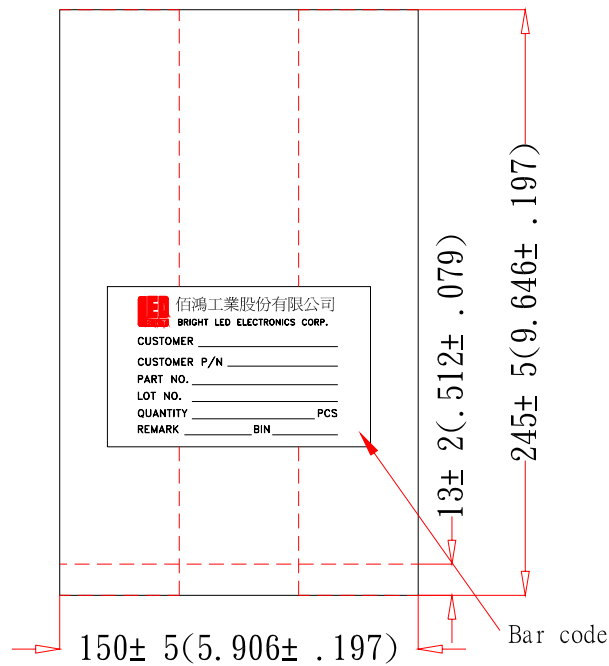

Notes:

1. 250pcs per bag, 1kpcs per box.
2. All Dimensions are in millimeters (inches).
3. Specifications are subject to change without notice.