

Subminiature Pushbutton Switch

CS Series

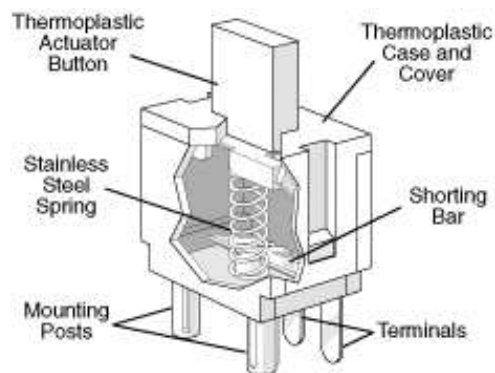
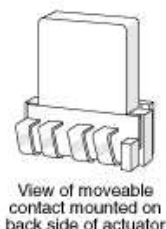
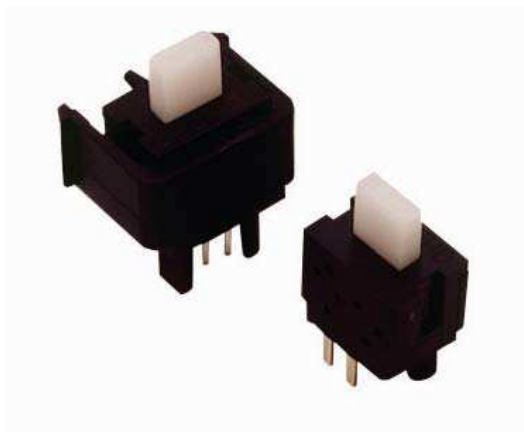

Specifications

Features

- 5mm stroke and 4mm overtravel give designers large mechanical margin
- Sliding contact technology ensure high reliability
- Snap-in panel mounting (vertical or horizontal) or pcb mounting

Electrical Ratings and Operating Life			
Switch Series	Nominal Load	Mechanical Life	Electrical Life
CS1	10mA, 24VDC	500,000 cycles min.	100,000 cycles min
CS3	10mA, 24VDC	500,000 cycles min.	100,000 cycles min.

Technical Specifications		Material Specifications	
Temperature Rating:	-25°C to +65°C (Max 85% RH)	Case and Cover:	PBT
		Terminals:	Brass (Silver Plated)
Flammability Rating:	CS1 UL94HB CS3: UL94V-0	Actuator Button:	CS1: POM CS3: PBT
Contact Resistance:	50m Ohm Max. (as initial value)	Shorting Bar:	Phosphor Bronze (Silver Plated)
Vibration Proof:	10-55Hz, peak to peak amplitude 1.5mm	Spring:	Stainless Steel
Shock Proof:	294m/s ² (30G)		

RoHS Compliant

Specifications subject to change without notice.

Dimensions mm

CS1A-A1AA

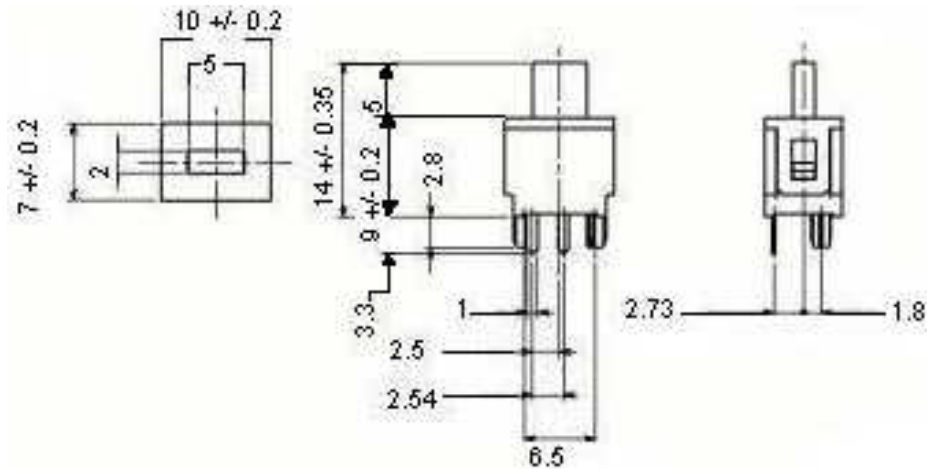

CS1A-B2BA

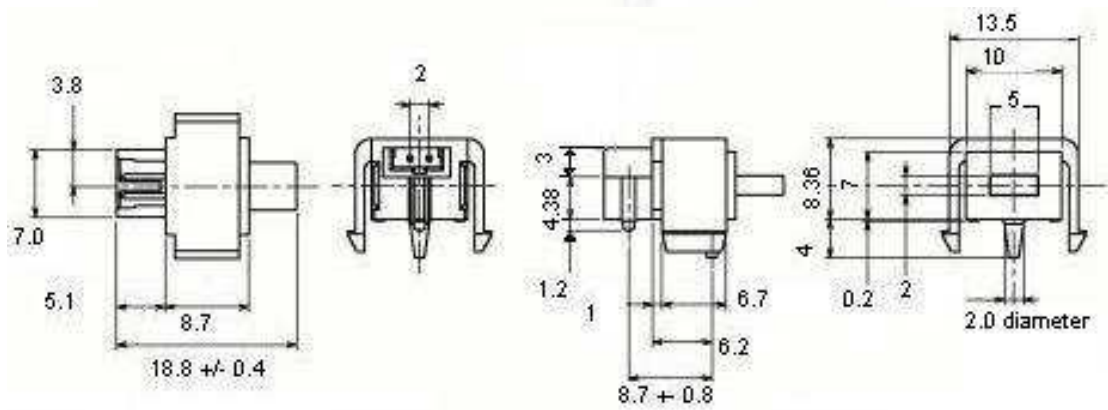

CS1A-C1CA

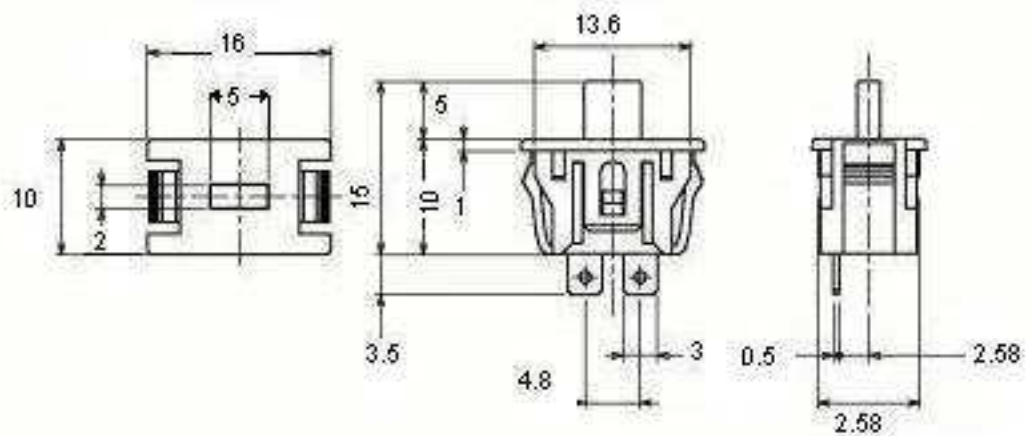

Specifications subject to change without notice.

CS1A-A1AA

CS1A-B2BA
CS3A-B2BA

CS1A-B2BA
CS3A-B2BA

Diagram illustrating the dimensions of the C S _ _ _ C _ structure. The horizontal dimension is labeled as 13.8 ± 0.05 , and the vertical dimension is labeled as 8.0 ± 0.05 .

The diagram illustrates the hierarchical structure of the product code 1A1B2C. Each digit in the code corresponds to a specific attribute, which is detailed in the following tables:

- CS (Series):**

Series
1
- 1 (Button Color / Material, Contact Rating, Operate Force):**

Code	Button Color / Material	Contact Rating	Operate Force cN max
1	Natural / POM	10mA 24VDC	84
3	Grey / PBT	10mA 24VDC	84
- A (Terminal Type):**

Code	Terminal Type
A	PCB
B	Pin
C	Solder
- 1 (Terminal Configuration):**

Code	Terminal Configuration
1	Straight
2	Connector
- B (Switch Type):**

Code	Switch Type
A	SPST NO
B	SPST NC
- C (Button Style):**

Code	Button Style
A	Standard

Contact

Technical data relates to product specifications only. Features may differ from those described. Only drawings combined with product specifications shall be deemed binding.

Last Updated:051711