

ADAPTERS, IN-SERIES

2.9mm , DC - 40 GHz, Flange Mount

SPECIFICATIONS:

Models: 5344

RoHS
Compliant

Electrical:	
Frequency Range _____	DC - 40 GHz
VSWR	
DC - 18 GHz _____	1.15:1 Max.
18 - 26.5 GHz _____	1.25:1 Max.
26.5 - 40 GHz _____	1.35:1 Max.
Impedance _____	50 Ohms
Operating Temp Range _____	-65°C to +125°C
Mechanical:	
2.9mm Connectors _____	Passivated Stainless Steel
Mates both Mechanically and Electrically with SMA, 3.5mm and K* Series Connectors	
Conductors _____	Gold Plated Beryllium Copper



* K is a Trademark of Anritsu Corp.

Model Number: **5344**
2.9mm Female/Female Connector

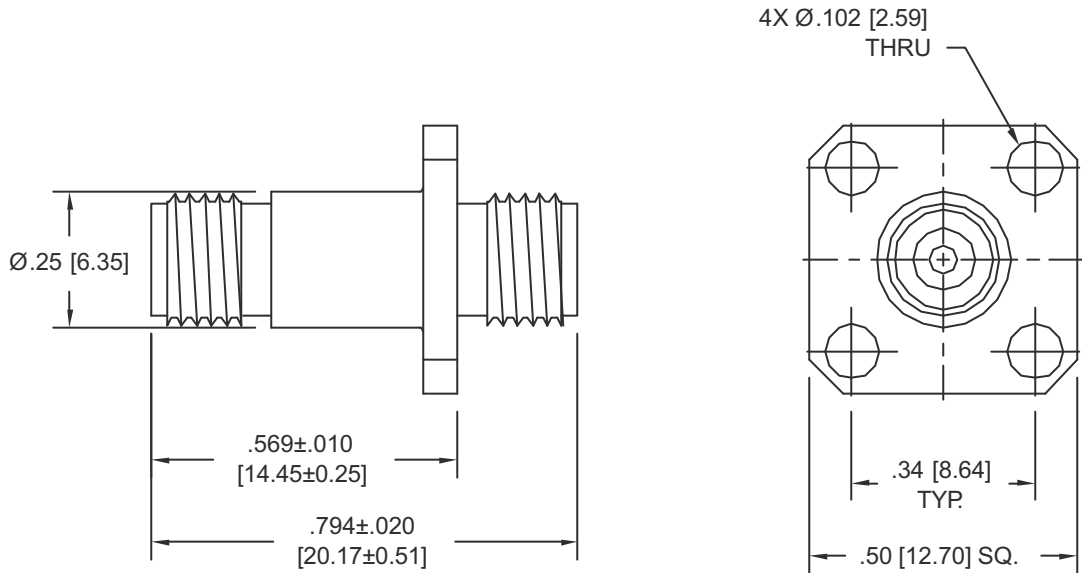

Note: Dimensions in Brackets are Expressed in Millimeters and are for Reference Only.

5344: REV -



Aeroflex / Inmet, Inc. • 300 Dino Drive, Ann Arbor, MI 48103 • U.S.A.
888-244-6638 or 734-426-5553 • FAX: 734-426-5557
www.aeroflex.com/inmet • inmet@aeroflex.com