

# ADAPTERS, IN-SERIES

SMA, DC - 26.5 GHz

## SPECIFICATIONS:

Models: 5163, 5164, 5165

**RoHS**  
Compliant

### Electrical:

Frequency Range \_\_\_\_\_ DC - 26.5 GHz  
VSWR \_\_\_\_\_ 1.20:1 Max.  
Impedance \_\_\_\_\_ 50 Ohms  
Operating Temp Range \_\_\_\_\_ -65°C to +125°C

### Mechanical:

Connectors \_\_\_\_\_ Passivated Stainless Steel  
Mates with MILSTD-348  
Conductors \_\_\_\_\_ Gold Plated Beryllium Copper

**AEROFLEX**  
A passion for performance.

Model Number: **5163**  
Female/Female Connectors

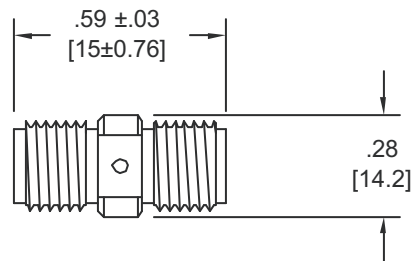

Model Number: **5164**  
Male/Male Connectors

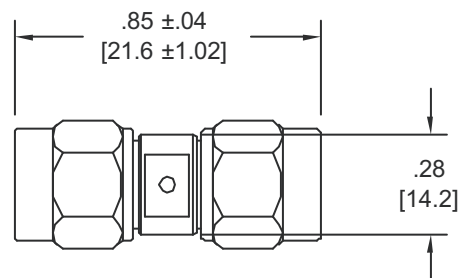

Model Number: **5165**  
Male/Female Connectors

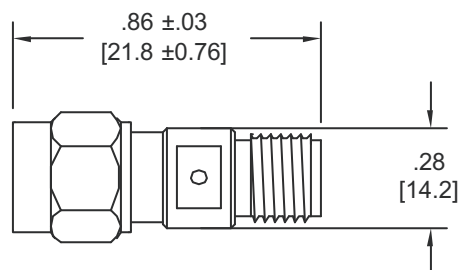

Note: Dimensions in Brackets are Expressed in Millimeters and are for Reference Only.

5163: REV A

**AEROFLEX**  
INMET

Aeroflex / Inmet, Inc. • 300 Dino Drive, Ann Arbor, MI 48103 • U.S.A.  
888-244-6638 or 734-426-5553 • FAX: 734-426-5557  
www.aeroflex.com/inmet • inmet@aeroflex.com