

## Through beam sensors

## FSAM 08D9002

## dimension drawing

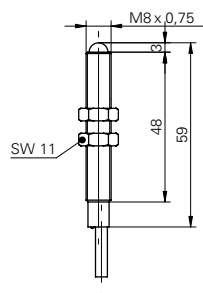

## general data

type	through beam sensor
emitter / receiver	emitter
light source	pulsed infrared diode
actual range $S_b$	2,5 m
nominal range $S_n$	3 m
wave length	880 nm

## electrical data

voltage supply range +Vs	10 ... 30 VDC
current consumption max. (no load)	48 mA
current consumption typ.	17 mA
reverse polarity protection	yes

## mechanical data

width / diameter	8 mm
height / length	59 mm
type	cylindrical
housing material	brass nickel plated
front (optics)	PC
connection types	cable 3 pin, 2 m

## ambient conditions

operating temperature	-25 ... +65 °C
protection class	IP 65

## photo



## connection diagram

