

Fork and angle sensors

FGUM 050P8001/S35L

dimension drawing

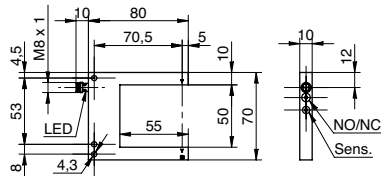

general data

| | |
|------------------------|---------------------|
| type | through beam sensor |
| object size | > 0,5 mm |
| repeat accuracy | < 0,04 mm |
| hysteresis | < 0,25 mm |
| ambient light immunity | < 80 kLux |
| sensitivity adjustment | potentiometer, 270° |
| light source | pulsed red LED |
| wave length | 660 nm |
| light indicator | LED yellow |

electrical data

| | |
|------------------------------------|---------------------------------|
| response time / release time | < 0,125 ms |
| switching frequency | < 4 kHz |
| voltage supply range +Vs | 10 ... 35 VDC |
| current consumption max. (no load) | 30 mA |
| output function | light / dark operate switchable |
| output circuit | PNP |
| voltage drop Vd | < 2,8 VDC |
| output current | < 200 mA |
| short circuit protection | yes |
| reverse polarity protection | yes |

mechanical data

| | |
|-------------------|---------------------|
| width / diameter | 70 mm |
| fork width Sb | 50 mm |
| height / length | 80 mm |
| penetration depth | 55 mm |
| depth | 10 mm |
| type | U profile |
| housing material | die-cast zinc |
| connection types | connector M8, 3 pin |

ambient conditions

| | |
|-----------------------|----------------|
| operating temperature | -10 ... +60 °C |
| protection class | IP 67 |

photo



connection diagram

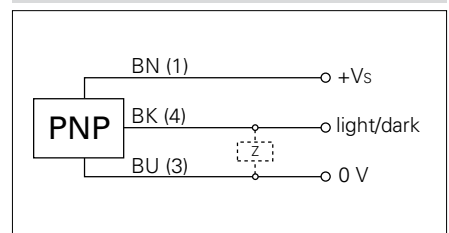

- accessories: PNP/NPN - converter