

## Capacitive proximity sensors

## CFDK 25G1155/LN2

## dimension drawing

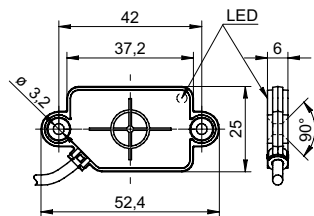

## general data

nominal sensing distance $S_n$	3 mm $\pm$ 1 mm
mounting type	shielded
GND electrode	no
temperature drift	$\pm$ 15 %
sensitivity adjustment	no
output indicator	LED red

## electrical data

voltage supply range +Vs	10 ... 30 VDC
current consumption max. (no load)	15 mA
output function	active high
output circuit	push-pull
output current	< 100 mA
voltage drop Vd	< 3 VDC
switching frequency	< 35 Hz
short circuit protection	yes
reverse polarity protection	yes

## mechanical data

type	rectangular
housing material	MABS
dimension	25 mm
housing length	52,4 mm
depth	6 mm
connection types	cable, 2 m

## ambient conditions

operating temperature	10 ... +65 °C
protection class	IP 65

## field of application

detection of non-conductive media	no
fill level detection through container	yes
liquids in direct contact	no
object detection	no

## photo



## connection diagram

